



Kirby Morgan Dive Systems, Inc.®

425 Garden Street, Santa Barbara, California 93101

Phone: 805/965-8538 Fax: 805/966-5761

www.KMDSI.com e-mail: info@KMDSI.com

New Product Bulletin #2 Of 2004 January 12, 2004

Subject: New Tri-Valve™ Exhaust Kit

Products Affected: All Kirby Morgan® SuperLite™ Helmets and Band Masks®

The patents pending **Tri-Valve™** Exhaust Kit, Part # 525-752 & 525-755 (SL 27 only), retrofits to all previous Kirby Morgan® SuperLite™ Helmets and KMB Band Masks®. It has been tested and certified to meet or exceed all requirements for all governing testing agencies.

The new **Tri-Valve™** Exhaust System has less breathing resistance than the older single valve exhaust while providing an extremely dry hat. The entire exhaust system and Whiskers™ are made of chemically resistant materials for use in polluted water and is quite robust.

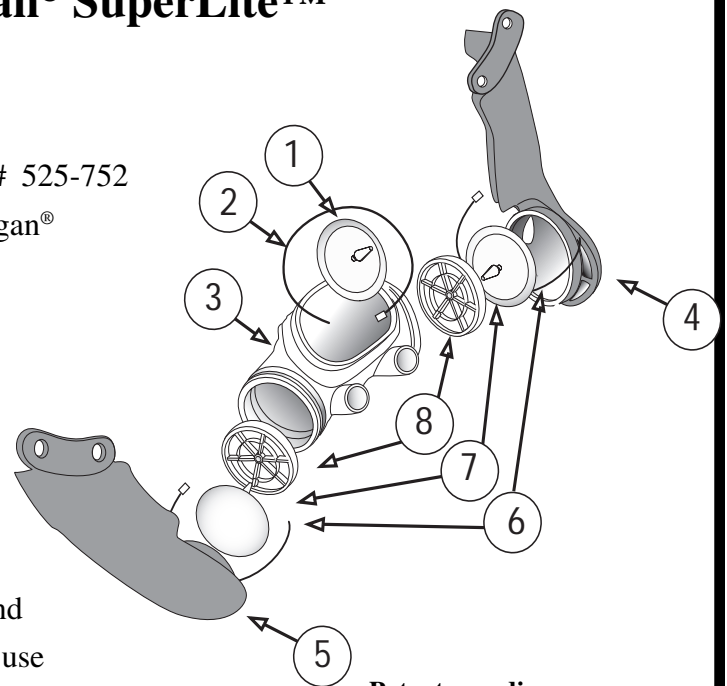

Patents pending

It will be shipped as standard on all new Kirby Morgan® Helmets and Band Masks® beginning February of 2004.

The **Tri-Valve™** is a very important advance in design. It provides a separate exhaust chamber after the exhaust gases exit the regulator. This traps any small drips of water within this chamber and ejects them, keeping the interior of the regulator very dry and isolated from the surrounding water. The unique, (patent pending), exterior channeling creates a relative low-pressure area on the exterior of the exhaust valve. This low-pressure area lowers the work of breathing and adds another barrier to water leaking in.