



# Kirby Morgan Dive Systems, Inc.®

1430 Jason Way Santa Maria, California 93455

Phone: 805/928-7772 Fax: 805/928-0342

www.KirbyMorgan.com email: kmdsi@KirbyMorgan.com

## Part #325-105 Deluxe First Stage Rebuild Kit

PART #	DESCRIPTION	QTY	PART #	DESCRIPTION	QTY
310-003	O-ring	4	410-010	O-ring	1
310-022	O-ring	1	430-060	Retainer Ring	1
310-023	O-ring	1	510-008	O-ring	1
310-115	O-ring	1	510-010	O-ring	1
330-320	Lock Nut	1	510-011	O-ring	1
350-120	Seat	1	510-012	O-ring	3
355-035	Filter	1	510-013	O-ring	2

**\*See next page for O-ring Identification**

Equipment used for air diving or diving with oxygen mixtures containing **LESS than 40% oxygen** can be lubricated with food-grade silicone, such as Molykote® 111 or equivalent. DO NOT mix types of lubes in the regulators. At a minimum, all helmet or BandMask® O-rings should be replaced at least once a year in accordance with the A2.1 checklist for the helmet or mask being inspected. During daily and monthly maintenance, O-rings and valves may be reused if no damage or deformation is found. O-rings and valves may require replacement more often than yearly if helmet or mask use is extreme, or if the helmet or mask is used in waters containing oil or chemical contamination. Daily cleaning and inspections, as well as the monthly inspection (A2.2 checklist), will more accurately identify the need than simply counting hours between overhauls. Store spare O-rings, valves, and soft goods in a cool, dark, dry place. Avoid prolonged exposure to temperatures above 90 °F (32 °C) and/or to ultraviolet rays. Do not lubricate exhaust valves and diaphragms. Lubricating valves can cause dirt to adhere, leading to leakage.

### ⚠ CAUTION

**Use only KMDSI original replacement parts. Using other manufacturers' parts will interfere with the performance of your life support equipment and may jeopardize your safety. Additionally, any substitutions will void any warranties offered by KMDSI. When ordering spares, always insist on Kirby Morgan Genuine Parts.**



# Kirby Morgan Dive Systems, Inc.®

1430 Jason Way Santa Maria, California 93455

Phone: 805/928-7772 Fax: 805/928-0342

www.KirbyMorgan.com email: kmdsi@KirbyMorgan.com

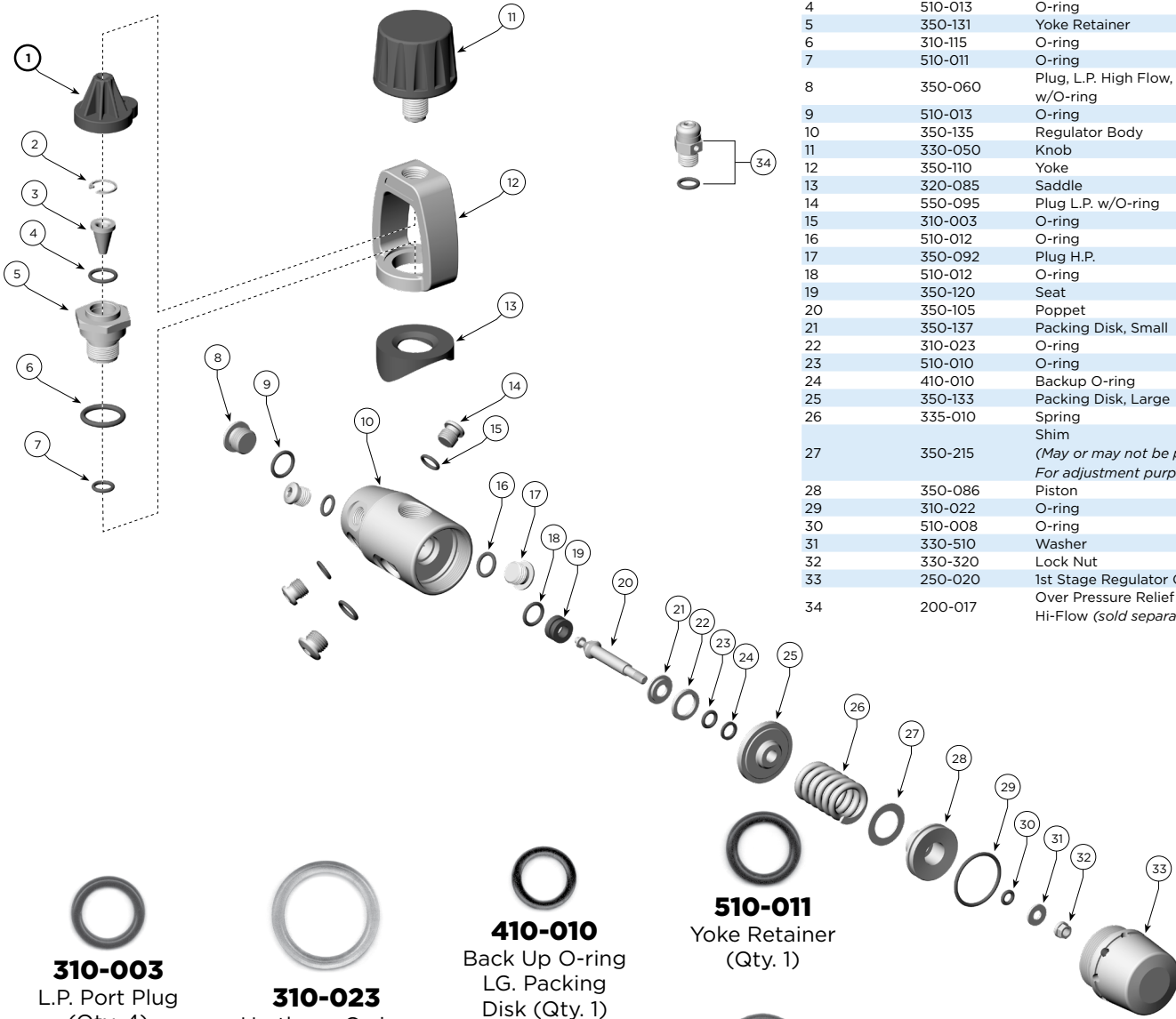

Location #	Part #	Description
1	410-025	Protector Cap
2	430-060	Retainer Ring
3	355-035	Filter
4	510-013	O-ring
5	350-131	Yoke Retainer
6	310-115	O-ring
7	510-011	O-ring
8	350-060	Plug, L.P. High Flow, w/O-ring
9	510-013	O-ring
10	350-135	Regulator Body
11	330-050	Knob
12	350-110	Yoke
13	320-085	Saddle
14	550-095	Plug L.P. w/O-ring
15	310-003	O-ring
16	510-012	O-ring
17	350-092	Plug H.P.
18	510-012	O-ring
19	350-120	Seat
20	350-105	Poppet
21	350-137	Packing Disk, Small
22	310-023	O-ring
23	510-010	O-ring
24	410-010	Backup O-ring
25	350-133	Packing Disk, Large
26	335-010	Spring
27	350-215	Shim (May or may not be present. For adjustment purposes)
28	350-086	Piston
29	310-022	O-ring
30	510-008	O-ring
31	330-510	Washer
32	330-320	Lock Nut
33	250-020	1st Stage Regulator Cap Over Pressure Relief Valve Hi-Flow (sold separately)
34	200-017	



**Cleaning Agent:** diluted vinegar solution  
**Lubricant:** Christo-Lube® or equivalent

**NOTE** When installing the seat, the concave end goes into the body first.

