

# SL 27® Water Dump

## Contents

### 27WTR-1 1.1 Water Dump Assembly On SL 27® Helmets

27WTR-1	1.1.1 Water Dump Valve Removal
27WTR-2	1.1.2 Water Dump Valve Replacement

27WTR-3	1.1.3 Purge Valve Body Removal and Replacement
27WTR-3	1.1.4 Purge Valve Body Installation
27WTR-3	1.1.5 Water Dump Valve Body Removal
27WTR-3	1.1.6 Water Dump Valve Body Remounting

### 1.1 Water Dump Assembly On SL 27® Helmets

The water dump assembly is mounted onto the bottom of the helmet by three screws that are installed from the inside of the helmet shell. RTV silicone sealant is used to seal the water dump body to the helmet shell.

The water dump body does not need to be removed to replace the valve, but should be removed for cleaning or replacement if corroded.

#### 1.1.1 Water Dump Valve Removal

##### Tools required:

- Flat Blade Screwdriver

1. The water purge deflector can be removed by cutting the tie wrap. If the deflector is badly cracked or rotted it should be replaced.

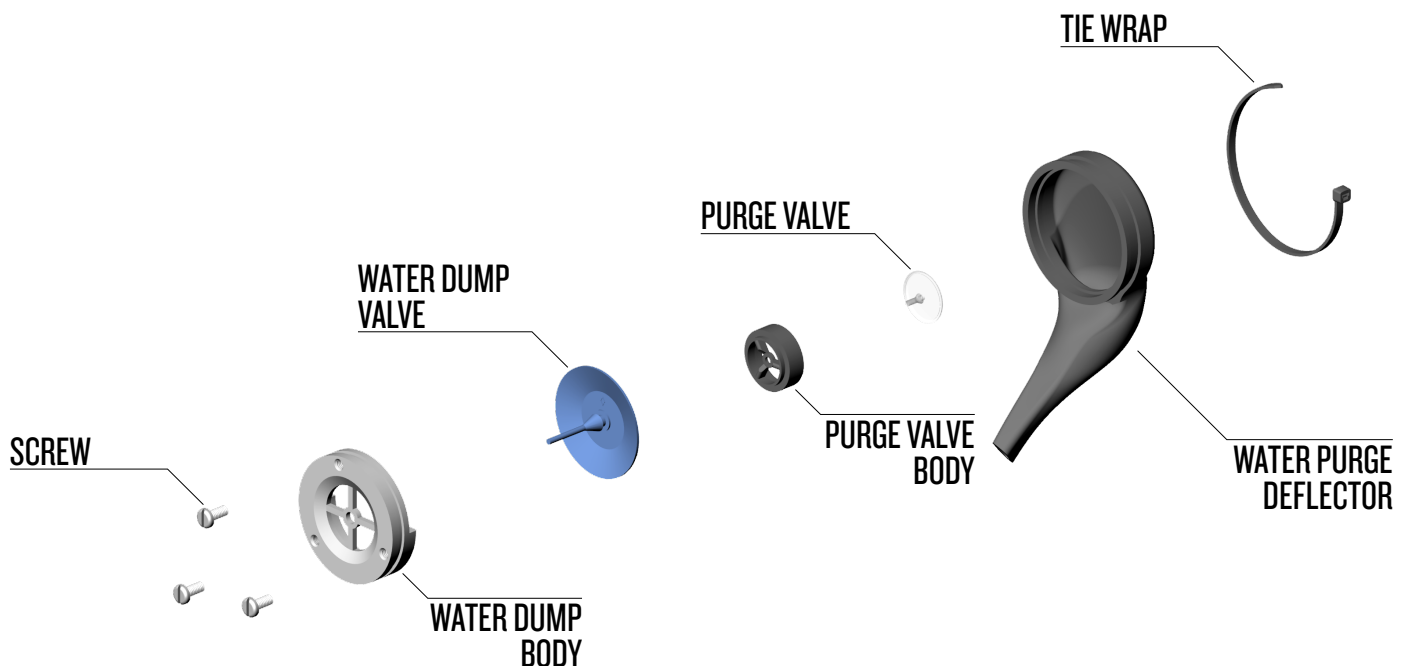

*The components of the water dump valve on the SuperLite® 27® are shown here.*



*The water purge deflector is removed by cutting the tie wrap that holds it in place.*

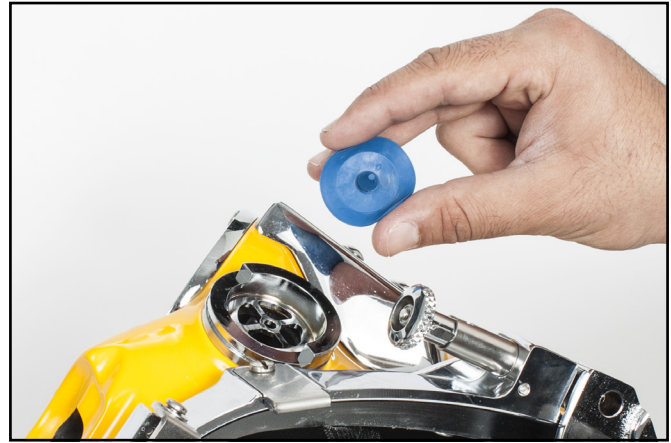

*The water dump valve should be replaced at least annually.*

2. The rubber exhaust valve should be replaced at the slightest sign of deterioration or aging of the rubber. Simply grasp the valve and pull to remove.

### 1.1.2 Water Dump Valve Replacement

1. The rubber exhaust valve is installed by inserting the center stem through the exhaust body then pulling from the inside of the helmet shell until it snaps into place.

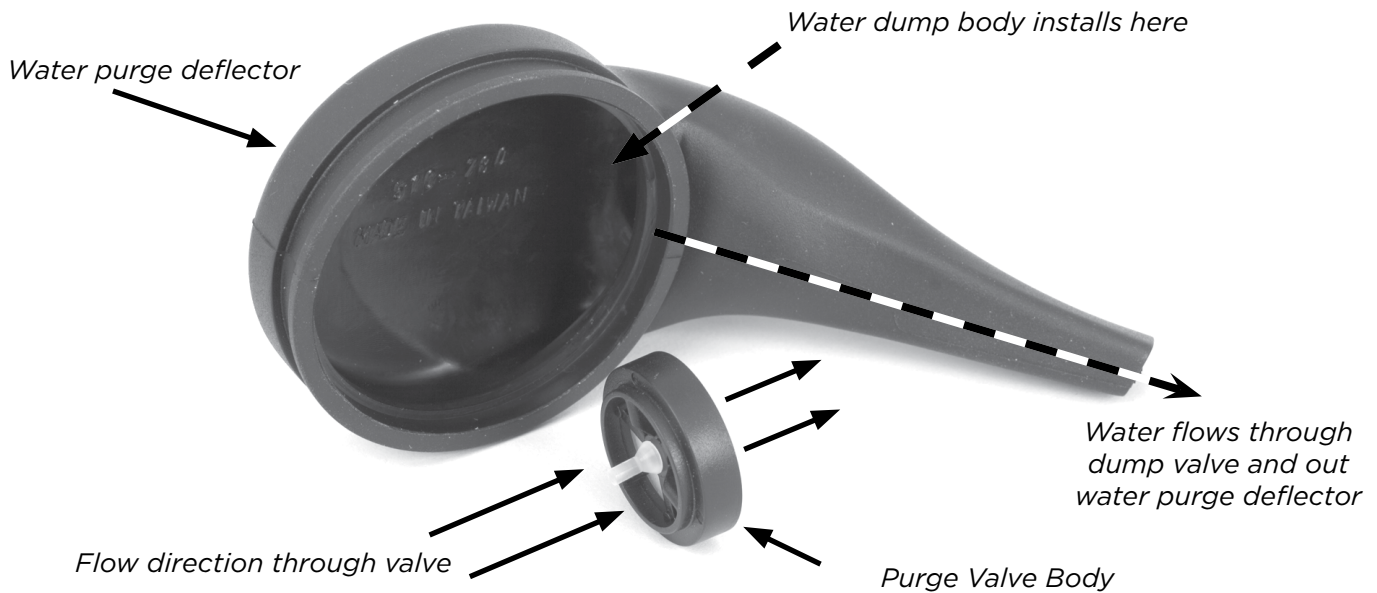



*The water dump valve on the SuperLite® 27 is protected by the water purge deflector shown here.*

2. When installing the water dump body be sure to never use longer screws than are called out on the exploded view. Longer screws will bottom out and may prevent the body from sealing properly against the helmet shell.

### 1.1.3 Purge Valve Body Removal and Replacement

The purge valve body fits inside the water purge deflector. It is a snap fit into a special groove designed for this purpose.

1. In order to inspect and/or replace the purge valve, you must remove the purge valve body. You can remove this easily by prying it out of the purge deflector with your finger.

Push the outer surface of the deflector where this inserted body is located, to dislodge it from its interior groove. You should be able to remove the valve and body by pulling out by hand. Avoid using any tools that could damage the surfaces of the valve body, unless the valve body is being replaced. Surface scars on the body may prevent sealing when re-installed.

2. Once the valve body is removed, inspect the valve to see if it is worn. If so, it should be replaced.

3. To replace the purge valve, hold the purge valve body with one hand and cut the stem from the existing valve.

4. Install a new valve in the body by snapping it into the purge valve body.

### 1.1.4 Purge Valve Body Installation



The purge valve body must be oriented correctly within the water purge deflector. If the valve is installed backwards, it will not function to quickly purge water from the helmet.

1. The purge valve body simply snaps into its groove in the water purge deflector.

2. Perform an exhale-and-inhale test. Gas should not escape when exhaling into the smaller opening of the deflector, and gas should flow freely when inhaling. This will confirm that the valve cage and valve are correctly seated.

### 1.1.5 Water Dump Valve Body Removal

1. The water dump body may need to be removed for cleaning or replacement if it has become corroded. A corroded water dump body may cause water to leak into the helmet.

If it is to be removed, you must first remove the three screws inside the helmet shell.

Prior to removal of the valve body, mark the helmet shell with a grease pencil so that the valve body is oriented properly, i.e., note the orientation of the slot on the top of the valve body. If the valve body is oriented improperly, the valve will not be able to dump water.

## ⚠ WARNING

**If the purge valve is not installed properly it will be impossible to purge water from the helmet through this valve. It must be installed with the proper orientation.**

After this is done, gently twist the valve body off of the helmet shell. A putty knife may be used to slide between the valve body and the shell to break the RTV sealant.

### 1.1.6 Water Dump Valve Body Remounting

#### Tools required:

- ¼ inch Flat Blade Attachment on Torque Screwdriver
- DOWSIL™ 732 or an Equivalent RTV Sealant

1. Apply silicone sealant DOWSIL™ 732 or an equivalent RTV sealant to the base of the exhaust body. Take care not to block the opening for the water dump valve.
2. Position the water dump body on the helmet shell. Note orientation of body. Install the screws and torque, using a torque screwdriver. See “Torque Specs” module. Wipe off any excess sealant. Make sure no silicone restricts the openings of the valve body.
3. Allow a 24 hour cure time before using the helmet. Install the new valve.

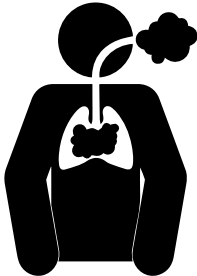
<b>⚠ WARNING</b>	
	<b>Do not breathe the fumes from uncured silicone sealant. These fumes are dangerous and can cause unconsciousness. They can also cause long term damage to body tissue. Read and follow all precautions listed on the silicone sealant tube.</b>