



Kirby Morgan Dive Systems, Inc.®

1430 Jason Way Santa Maria, California 93455

Phone: 805/928-7772 Fax: 805/928-0342

www.KirbyMorgan.com email: kmdsi@KirbyMorgan.com

Part #425-165 O-ring Rebuild Kit

Location #	Description	Qty
A	O-ring	2
B	Tip Internal O-ring	2
C	Din Primary Seal O-ring	2
	Bleeder Screw Assembly	2

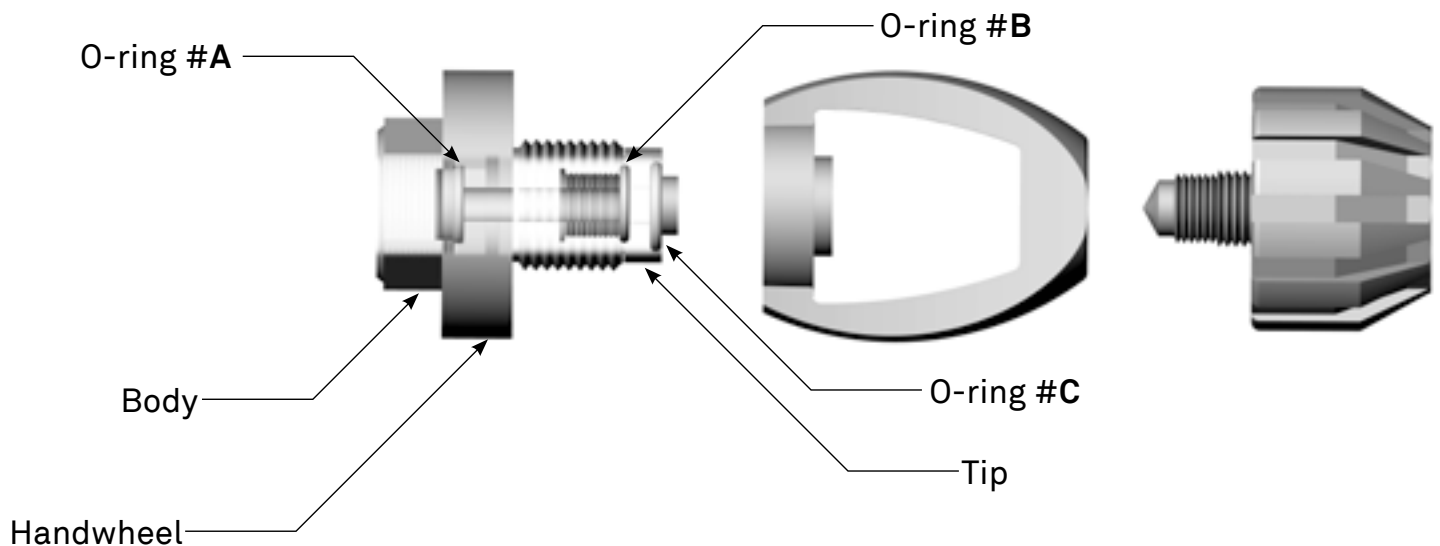

DIN Fitting

1. Remove bleeder screw, inspect the nylon seat, the threads on the screw and in the block. Replace this part if the threads are worn or the seat becomes so deeply grooved that it allows air leakage. It is recommended that you replace the entire assembly because the threads can wear out prematurely and forcibly fail under certain conditions. Lubricate the threads with any grease compatible with breathing media.
2. Place the block in a padded vise, and use a $\frac{7}{8}$ " open-end wrench to remove the DIN fitting from the block. Place the DIN fitting in the vise and unscrew the tip fitting with a $\frac{1}{4}$ " Allen-key wrench. You now have 3 parts: The DIN tip, the DIN body, and the handwheel. Clean these parts in a suitable acidic solvent to remove salt deposits and other contaminants. (Ultrasonic treatments work well.) Remove all traces of thread-sealer from the threads of the DIN tip.
3. Inspect the DIN body and replace its inner O-ring (#A). Press this O-ring into its groove with a blunt tool so it does not fall out during reassembly. Place the DIN body in a vise and slide the handwheel over the DIN body (threads upward). Inspect the threads of the DIN tip to be sure all remnants of thread-sealing compound have

Kirby Morgan Dive Systems, Inc.®

1430 Jason Way Santa Maria, California 93455

Phone: 805/928-7772 Fax: 805/928-0342

www.KirbyMorgan.com email: kmdsi@KirbyMorgan.com



been removed. Put a new O-ring (#B) on the threaded neck of the DIN tip and a new primary seal O-ring (#C) in the tip's groove.

⚠ WARNING

Do not use a "permanent type" thread sealing such as Loctite® 290 or 271 for this application. They will permanently freeze these components together, making future repairs impossible.

4. Check to make sure that the DIN body O-ring is in place and screw the DIN assembly back onto the bleeder block. Begin this operation carefully by hand, since very fine threads are used on the block and cross-threading can easily occur. Tighten (torque: 25 - 30 ft. lbs.) the DIN fitting onto the block with a 7/8" wrench.

⚠ CAUTION

Use only KMDSI original replacement parts. The use of other manufacturers' parts will interfere with the performance characteristics of your life support equipment and may jeopardize your safety. Additionally, any substitutions will void any warranties offered by KMDSI. When ordering spares, always insist on Kirby Morgan Genuine Parts.