



# Kirby Morgan Dive Systems, Inc.®

1430 Jason Way Santa Maria, California 93455

Phone: 805/928-7772 Fax: 805/928-0342

www.KirbyMorgan.com email: kmdsi@KirbyMorgan.com

## Part #525-390 KM 37SS Water Shroud Kit Installation Instructions

PART #	DESCRIPTION	QTY	PART #	DESCRIPTION	QTY
510-599	Shroud, Regulator	1	520-039	Tie Wrap	6
510-734	Side Block Shroud	1	520-049	Tie Wrap	4
510-736	Water Tube-A	1	550-572	Adapter Sleeve	1
510-737	Water Tube-B	1	550-580	Adapter Sleeve, Long	1

### Tools Required:

- Torque Wrench
- 1<sup>1</sup>/<sub>6</sub>, 7<sup>8</sup> and 1 inch Open End Attachments
- 1<sup>3</sup>/<sub>6</sub>, 7<sup>8</sup> and 1 inch Open Ended Wrench
- 1/4 inch Flat Blade Screwdriver
- Small Cutting Pliers

### Side Block Shroud

#### NUMBERS REFER TO STEPS AT RIGHT

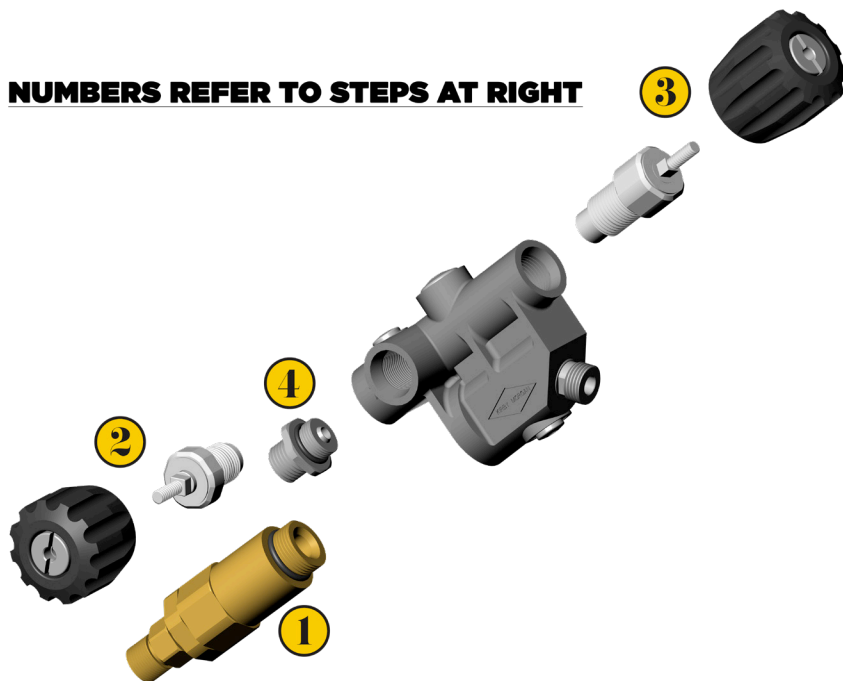

1) Remove the one way valve assembly from the side block.

2) Remove the emergency valve control knob and all parts down to the seat assembly.

3) Remove the steady flow control knob and all parts down to the seat assembly.

4) Remove the bailout hose fitting.



# Kirby Morgan Dive Systems, Inc.®

1430 Jason Way Santa Maria, California 93455

Phone: 805/928-7772 Fax: 805/928-0342

www.KirbyMorgan.com email: kmddsi@KirbyMorgan.com



5) Remove the bent tube assembly. Refer to “1.3.1 Removal of the Bent Tube Assembly” on page BNT-4 in the KMDSI modular manual.

6) Install the side block shroud starting at the bailout end.

Fit the shroud onto the block while progressing towards the front of the block. Make certain the shroud is positioned properly. The fit should be snug and everything should align.



7) Reinstall all of the side block parts that were removed except the bent tube assembly and torque. Refer to “1.3.3 Reassembly of the Defogger Valve” on page SSB-8 and “1.4.3 Reassembly of Emergency Valve (EGS Valve)” on page SSB-13 in the KMDSI modular manual.

## Regulator Shroud

8) Screw the regulator adjustment knob all the way in.

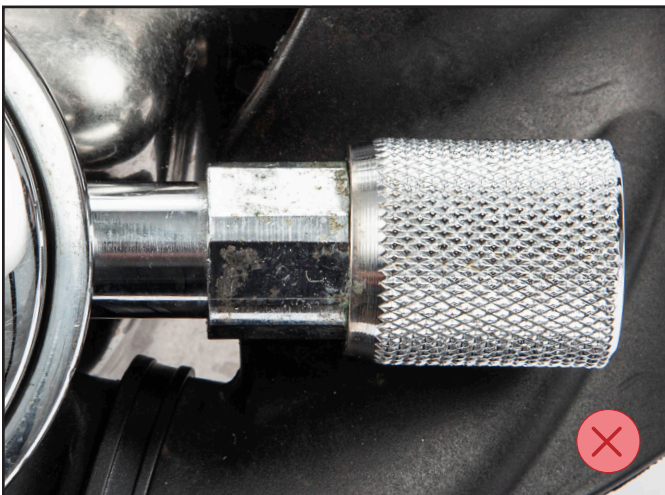





# Kirby Morgan Dive Systems, Inc.®

1430 Jason Way Santa Maria, California 93455

Phone: 805/928-7772 Fax: 805/928-0342

www.KirbyMorgan.com email: kmdsi@KirbyMorgan.com



9) Fit the adapter sleeve (short), P/N 550-572 into the inlet side of the regulator shroud with the channeled end facing out of the leading edge of the shroud.



10) Using the narrow tie wrap P/N 520-049, secure sleeve to shroud. Ensure the leading edge of the shroud is pushed flush to the edge of the upraised channel found on the adapter sleeve.

11) Swing the bent tube away from the side block and install the regulator shroud over the bent tube assembly and stretch it over the regulator adjustment knob.



# Kirby Morgan Dive Systems, Inc.®

1430 Jason Way Santa Maria, California 93455

Phone: 805/928-7772 Fax: 805/928-0342

www.KirbyMorgan.com email: kmdsi@KirbyMorgan.com



## Bent Tube



12) Swing the bent tube away from the side block and put the adapter sleeve (short), P/N 550-572, onto the bent tube assembly first, channeled end facing away from regulator inlet.



13) Line up the bent tube mount nut to the side block. Complete installation of bent tube assembly. Refer to "1.2.3 Installation of the Bent Tube Assembly" on page BNT-2 from the KMDSI modular manual.

14) Once the bent tube is secured and torqued to the correct values, insert the adapter sleeve into the side block end, smooth side in, channeled side out.



15) Line up the detail features of water tubes A & B, with the mating details of both adapter sleeves.





# Kirby Morgan Dive Systems, Inc.®

1430 Jason Way Santa Maria, California 93455

Phone: 805/928-7772 Fax: 805/928-0342

www.KirbyMorgan.com email: kmdsi@KirbyMorgan.com



16) Using the narrower tie wrap, P/N 520-049, (represented by the gold color in the photo), secure the long adapter sleeve to the side block shroud.

17) Use the three wider tie wraps P/N 520-039 (represented by the purple color in the photo) to secure the two tubes together, one in the middle and one on each of the leading edges of the tube. Little to no gap should be evident between the two tubes.

Generally between one-two gallons per minute of water flow is plenty to heat the incoming gas or to keep the interior clean of debris without interfering with the regulator diaphragm. Water flow arrow is found on the A tube and should be positioned farthest away from the helmet (on the outside)

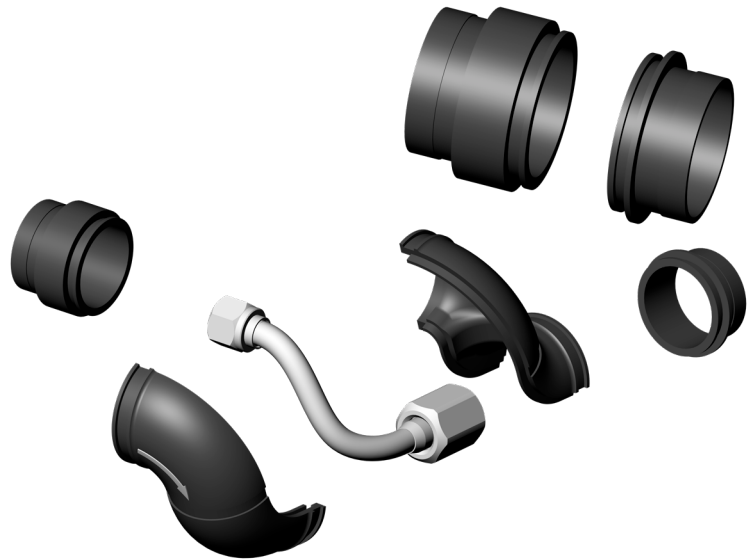

# Kirby Morgan Dive Systems, Inc.®

1430 Jason Way Santa Maria, California 93455

Phone: 805/928-7772 Fax: 805/928-0342

www.KirbyMorgan.com email: kmdsi@KirbyMorgan.com



*This page intentionally left blank.*



Kirby Morgan Dive Systems, Inc.  
1430 Jason Way  
Santa Maria, CA 93455, USA  
Telephone (805) 928-7772, FAX (805) 928-0342  
E-Mail: [KMDSI@KirbyMorgan.com](mailto:KMDSI@KirbyMorgan.com), Web Site: [www.KirbyMorgan.com](http://www.KirbyMorgan.com)