

# Manifold Block Assembly

## P/Ns 300-145, 300-150, 300-155

Location #	Part #	Description
1	550-019	Locknut
2	535-802	Spring
3	520-525	Flex Knob, Emergency Valve
4	550-091	Packing Nut
5	520-024	Packing
6	540-095	Packing Washer
7	550-138	Valve Stem, Emergency
8	550-140	Emergency Valve Body
9	505-070	Emergency Valve Assembly
10	310-003	O-ring
11	550-095	Plug, L.P. w/O-ring
12	510-483	O-ring
13	Order 555-195	One-Way Valve

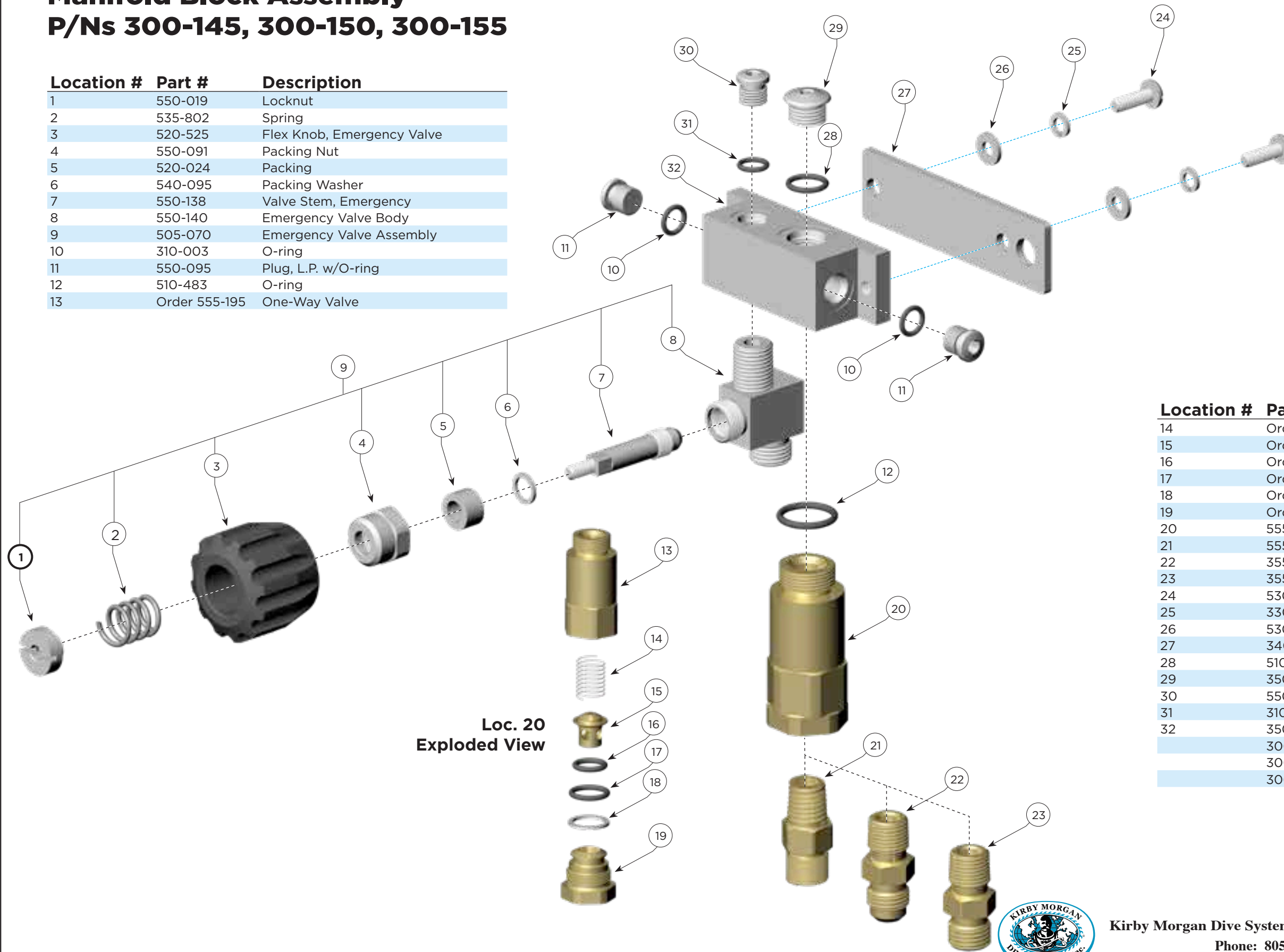

**Loc. 20**  
**Exploded View**

Location #	Part #	Description
14	Order 525-330	Spring
15	Order 555-195	Poppet
16	Order 525-330	O-ring
17	Order 525-330	O-ring
18	Order 525-330	Wiper
19	Order 555-195	Seat
20	555-195	One Way Valve
21	555-117	Adapter, Brass O2 (for 300-150)
22	355-225	Adapter, Brass #6 JIC (for 300-155)
23	355-205	SCUBA Adapter (for 300-145)
24	530-070	Screw
25	330-405	Lock washer
26	530-527	Washer
27	340-011	Backing Plate
28	510-013	O-ring
29	350-060	Plug, Large w/O-ring
30	550-095	Plug, L.P. w/O-ring
31	310-003	O-ring
32	350-050	Manifold Block
	300-145	Manifold Block w/SCUBA Adapter
	300-150	Manifold Block w/1/4 O2 Adapter
	300-155	Manifold Block w/#6 JIC Adapter



Kirby Morgan Dive Systems, Inc.® 1430 Jason Way, Santa Maria, CA 93455

Phone: 805/928-7772 Fax: 805/928-0342

[www.KirbyMorgan.com](http://www.KirbyMorgan.com) e-mail: [kmdsi@KirbyMorgan.com](mailto:kmdsi@KirbyMorgan.com)