

REX[®] Regulator Assembly P/N 505-278 (Order P/N 525-774)

Location #	Part #	Description
1	560-514	Regulator Body, REX
2	350-035	Sleeve
3	510-015	O-ring
4	350-065	Spacer
5	535-910	Spring
6	350-052	Adjustment Shaft
7	510-011	O-ring
8	350-025	Packing Nut
9	320-035	Adjustment Knob
10	530-601	Retaining Pin
11	305-045	Adjustment Knob Assembly
12	510-777	Exhaust Valve, REX Regulator
13	510-783	Whisker, Main Body, REX
14	520-038	Tie-Wrap
15	520-042	11" Tie Wrap
16	510-785	Port Whisker Wing, REX
17	550-042	Cover Retaining Ring
18	510-006	Cover, REX
19	320-030	Washer
20	510-553	Diaphragm
21	520-200	Valve Seat
22	510-776	Exhaust Valve

Location #	Part #	Description
23	510-784	Starboard Whisker Wing, REX
24	525-764	REX Whisker Wing Exhaust Kit
25	310-013	O-ring
26	545-038	Roller Lever Arm Assembly
27	350-143	Main Tube, Stainless Steel
28	310-013	O-ring

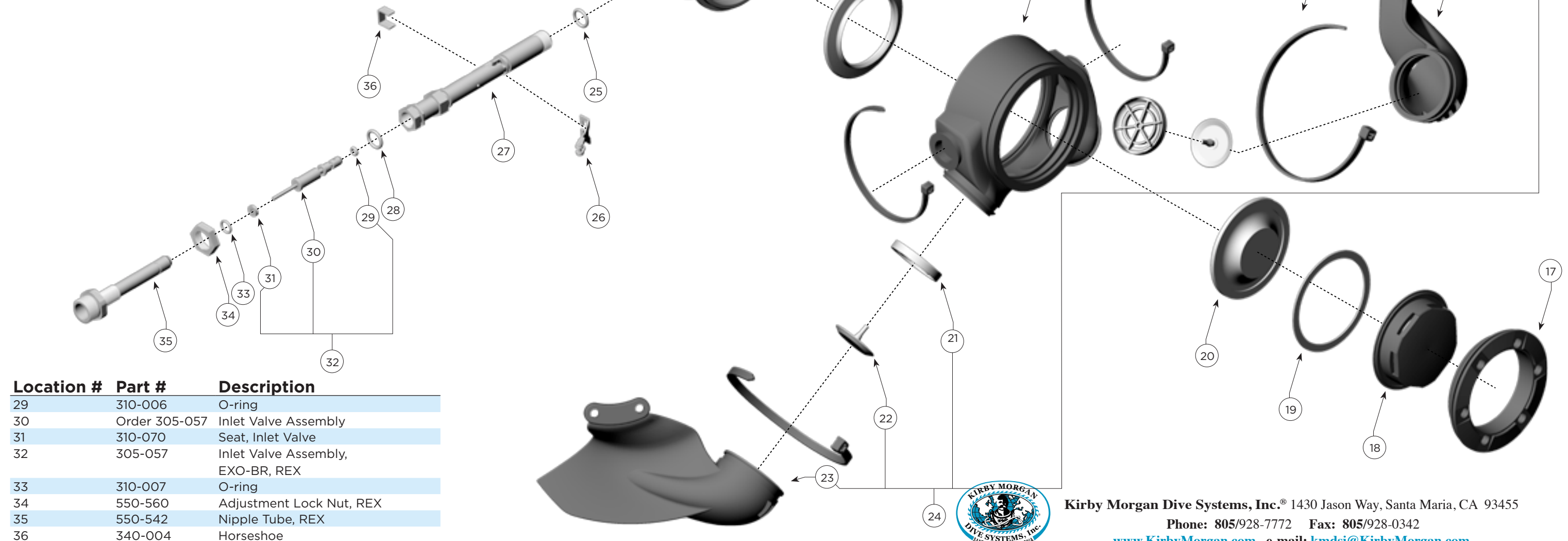

Location #	Part #	Description
29	310-006	O-ring
30	Order 305-057	Inlet Valve Assembly
31	310-070	Seat, Inlet Valve
32	305-057	Inlet Valve Assembly, EXO-BR, REX
33	310-007	O-ring
34	550-560	Adjustment Lock Nut, REX
35	550-542	Nipple Tube, REX
36	340-004	Horseshoe

Kirby Morgan Dive Systems, Inc. 1430 Jason Way, Santa Maria, CA 93455
 Phone: 805/928-7772 Fax: 805/928-0342
www.KirbyMorgan.com e-mail: kmdsi@KirbyMorgan.com